

DIESEL GENERATOR DATA SHEET

HIPOWER DIESEL GENERATOR Powered by Cummins Model:PGD625C



*Drawing above for illustration purposes only

I . GENERAL DATA

| | | | |
|---------------------|--------|----------------|------|
| Prime Power | kW/kVA | 450 | 563 |
| Standby Power | kW/kVA | 500 | 625 |
| Frequency | Hz/rpm | 60 | 1800 |
| Voltage | v | 208 | 120 |
| Current | A | 1735 | |
| Connection | / | 3P 4W/Y | |
| Rated Power Factor | / | 0.8 | |
| Open Type (LxWxH) | mm | 3500x1345x2110 | |
| Open Type(Weight) | kg | 4300 | |
| Silent Type (LxWxH) | mm | 4800x2100x2280 | |
| Silent Type(Weight) | kg | 5500 | |

■ Available for voltages 400/230V, 480/277V, 380/220V, 440/254V, 416/240V, 220/127V, 208/120V

■ All datas based on ISO 3046, altitude 100m (328ft), barometric pressure 100kPa (29.53inHg), air temperature 25°C (77°F), relative humidity 30%.

■ Please contact with engineer for correct generator capacity selection when the load application can't meet with the standard reference.

■ diesel generators comply with standards :ISO8528,ISO 14000,ISO3046,GB755,BS5000,VDE0530,IEC34-1

II. STANDARD CONFIGURATION

| | |
|--------------------------|---|
| Engine | Cummins, including air filters, fuel filters, oil filter, starting motor and charging alternator etc. |
| Alternator | brushless AC alternator |
| Radiator | Silent Type 50°C (Open Type 40°C) , fan protective shroud |
| Base Frame | ≤550KW: base mounted fuel tank, anti-vibration pads, battery holder > 550KW: channel steel base frame, anti-vibration pads, battery holder |
| Circuit Breaker | ≤1250A : Molded case circuit breaker(MCCB) |
| Control System | DEEP SEA 6020 |
| Start Battery | Dry charged battery, available for 6 times starts under standard condition; connection cables. |
| Installation Accessories | Bellow, Elbow and flange, Exhaust silencer, etc. |
| Tool | standard |
| Documents | Electric drawing, operation & maintenance manual, certification etc. |

III. OPTIONAL CONFIGURATION

| | |
|----------------------------|---|
| Engine Accessories | <input type="checkbox"/> Heavy-duty air filter <input type="checkbox"/> Coolant heater <input type="checkbox"/> Lub oil heater <input type="checkbox"/> Fuel and Water Separator |
| Alternator And Accessories | <input type="checkbox"/> Stamford <input type="checkbox"/> Leroy Somer <input type="checkbox"/> Marathon <input type="checkbox"/> Anti condensation heater <input type="checkbox"/> PMG <input type="checkbox"/> High voltage _____ kV |
| Cooling System | <input type="checkbox"/> 50°C radiator <input type="checkbox"/> Heat exchanger + water cooling tower + External water circulation pumping system <input type="checkbox"/> Remote horizontal water tank system |
| Control System | <input type="checkbox"/> AMF <input type="checkbox"/> Parallel <input type="checkbox"/> Practical type in low temperature environment <input type="checkbox"/> Control Screen Heater <input type="checkbox"/> Other (Comap、 DEIF) |
| Circuit Breaker | <input type="checkbox"/> 3/4 poles <input type="checkbox"/> Fixed/handcart type <input type="checkbox"/> Electric mechanism |
| Automatic Transfer Swtich | <input type="checkbox"/> ATS cabinet |
| Start Battery | <input type="checkbox"/> Nickel-cadmium battery <input type="checkbox"/> Maintenance-free battery <input type="checkbox"/> Power charger and selector <input type="checkbox"/> Charging current meter |

DIESEL GENERATOR DATA SHEET

External Fuel Tank ◇ 500L ◇ 1000L ◇ 1500L ◇ 2000L ◇ 2500L ◇ 3000L ◇ 4000L ◇ 5000L

Others _____

IV. ENGINE DATA

| | | | | |
|------------------|----------------------------|-------------------|---------|-----|
| Engine Model | KTA19-G4/G3A | Engine Power | 563 | kW |
| Aspiration | Turbocharged & Aftercooled | Displacement | 19 | L |
| Type | In-line | Bore×Stroke | 159×159 | mm |
| No. of Cylinders | 6 | Compression Ratio | 13.9:1 | |
| Governor Type | Electronic Governor | Rated Speed | 1800 | RPM |

■ Fuel System

| | | | | |
|------------------------------|--|-----|--------------------------------|--------|
| Prime Power Fuel Consumption | 120 | L/h | Standby Power Fuel Consumption | 133 |
| Fuel # | ASTM D975 No.2-D or BS2869 1998 Class A1, A2 | | Injection System | L/h PT |

■ Lubrication System

| | | | | |
|------------------|----------------|---|-----------------|-------------|
| Lub Oil Capacity | 50 | L | | |
| Lub # | API CF-4 15W40 | | Max.Temperature | 121 °C |

■ Coolant System

| | | | | |
|------------------------------------|---------|--------|---------------------|-------------|
| Coolant Capacity | 85.3 | L | Max. Top Tank Temp. | 104 °C |
| Std. Thermostat (Modulating) Range | 82 - 93 | °C | Fan Drive Method | Shaft drive |
| Cooling Fan Air Flow | 828 | m3/min | | |

■ Air Intake System

| | | | | | |
|---------------------|-------------|--------|--------------------------------|-----|-----|
| Combustion Air Flow | 41.22/42.96 | m3/min | Maximum Air Intake Restriction | 3.7 | kPa |
|---------------------|-------------|--------|--------------------------------|-----|-----|

■ Exhaust System

| | | | | | |
|------------------|---------|--------|-------------------|----|-----|
| Exhaust Gas Flow | 104/112 | m3/min | Max.Back Pressure | 10 | kPa |
|------------------|---------|--------|-------------------|----|-----|

DIESEL GENERATOR DATA SHEET

Exhaust Gas Temp ≤504 °C Exhaust Pipe Size φ150 mm

■ Starting System

Start Mode DC24V Electric start Battery 2x200 Ah

V. ALTERNATOR DATA

| | | | | |
|----------------------|----------|--------------------|--------------|--------|
| Alternator Model | SLG354D | Rate Power | 475/594 | kW/kVA |
| PF. | 0.8 | Voltage | 440/254 | V |
| Phase | 3 | Frequency | 60 | Hz |
| Connection | 3P 4W/Y | Bearing | 1 | |
| Winding Pitch | 2/3 | Protection Class | IP21 | |
| Insulation Class | H | Efficiency | 94.1% | |
| Tel. Influence | TIF: <50 | Voltage Regulation | ±1.0% | |
| Harmonic Coefficient | THF: <2% | AVR | AS440 | |
| Voltage Adjust Scope | ≥±5% | Excitation System | Self Excited | |

VI. CONTROL SYSTEM DATA

MODEL DSE6020

■ Main feature

Electronic J1939 (CAN) and nonelectronic MPU and alternator sensing engine support for diesel, gas and petrol engines all in one variant. With a number of flexible inputs, outputs and protections, the modules can be easily adapted to suit a wide range of applications.



■ Key Function

- | | | |
|--|---|--|
| ▲Utility voltage sensing | ▲Configurable staged loading outputs | ▲Configurable remote start input |
| ▲Generator/load power monitoring (kW, kV A, kV Ar, pf) | ▲CAN, MPU and alternator speed sensing in one variant | ▲Alternative configuration |
| ▲Generator overload protection (kW) | ▲3 engine maintenance alarms | ▲Alarm including common alarm, common electric and common shutdown |
| ▲Efficient power save mode | ▲Engine speed protection | ▲LCD and LED alarm indication |
| ▲Mains and generator closed via | ▲Engine pre-heat | ▲Configurable event log (50) |

DIESEL GENERATOR DATA SHEET

front panel

- ▲ 4 configurable DC outputs
- ▲ 4 configurable analog./digital inputs
- ▲ 6 configurable digital inputs
- ▲ Support for 0-10 V & 4-20 mA oil pressure sensors

- ▲ Multiple date and time scheduler
- ▲ Engine idle control for starting & stopping
- ▲ Fuel pump control
- ▲ Battery voltage monitoring
- ▲ Start on low battery voltage

▲ Heated display option available

☆ *For more information, please visit the [official website](#)*

VII. WARRANTY POLICY

1. Guarantee for three years or 2000 hours (accord to whichever reach first) from ex-factory date. Refer to 《 Diesel Generator Warranty Manual》 for more details.
2. Wearing parts(filters), incorrect man-made operation, maintenance failures are excluded from the warranty policy

VIII. DRAWING (for illustration purposes only)

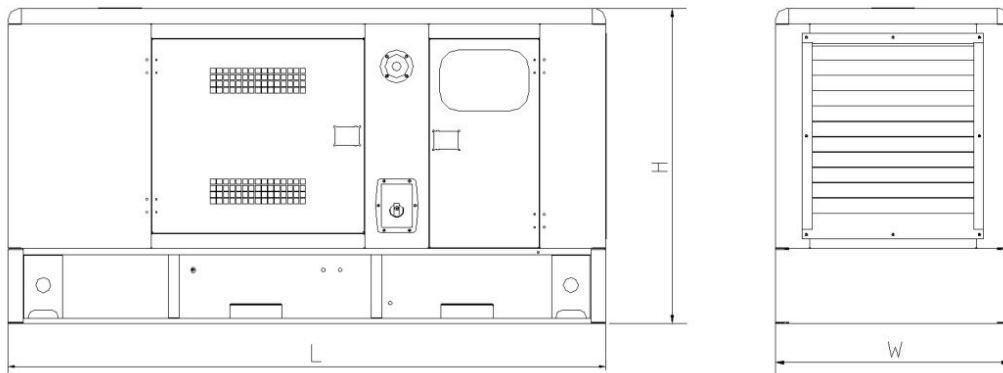
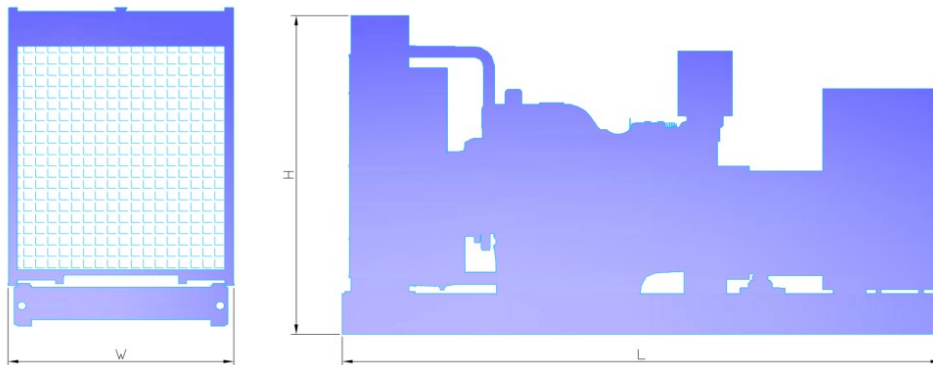

Cumple con UL STD 2200 Certificado para
 CSA STD C22.2 # 100 Certificado para CSA
 STD C22.2 # 14

